

Green Box - factsheet

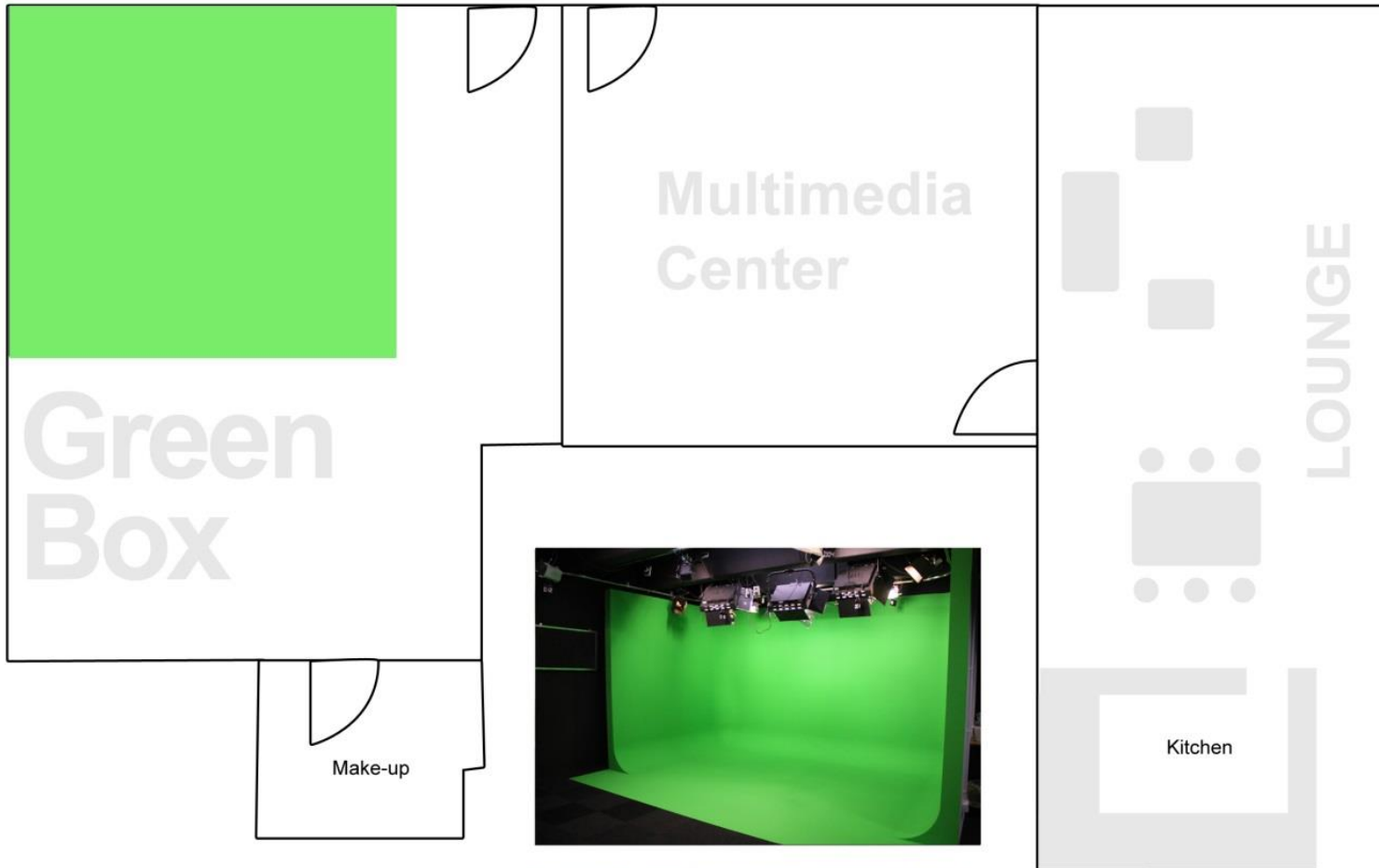

Measures and technical features:

Length:	9.50 m
Width:	7.25 m
Surface area:	55 sqm
Green Box length:	5.00 m
Green Box width:	3.20 m
Green Box area:	16 sqm

Light: 1*sunburst softlight
 3* 2KW single dimmer with fader control
 2* 500W fresnel spotlight Mizar
 2 * 500W fresnel spotlight Magis
 5* Nesys Softlight 660

The Green Box is integrated into the producer area on the nobeo facilities as a stand-alone studio. This allows for flexible technological equipment with EB cameras.

In addition, the connection to nobeo's multimedia centre additionally allows direct recordings as Avid projects

Comfortable lounge area

Integrated make-up and dress room

Large parking facilities for team and viewers in close proximity

More information at
www.nobeo.de or sales@nobeo.de